

Detaliu Nr. 15A:PODET TUBULAR LA DRUMURI LATERALE

Detail No. 15A: TUBE CULVERT FOR SIDE ROADS

Scara / Scale 1:50

SECTIUNE A-A / A-A SECTION

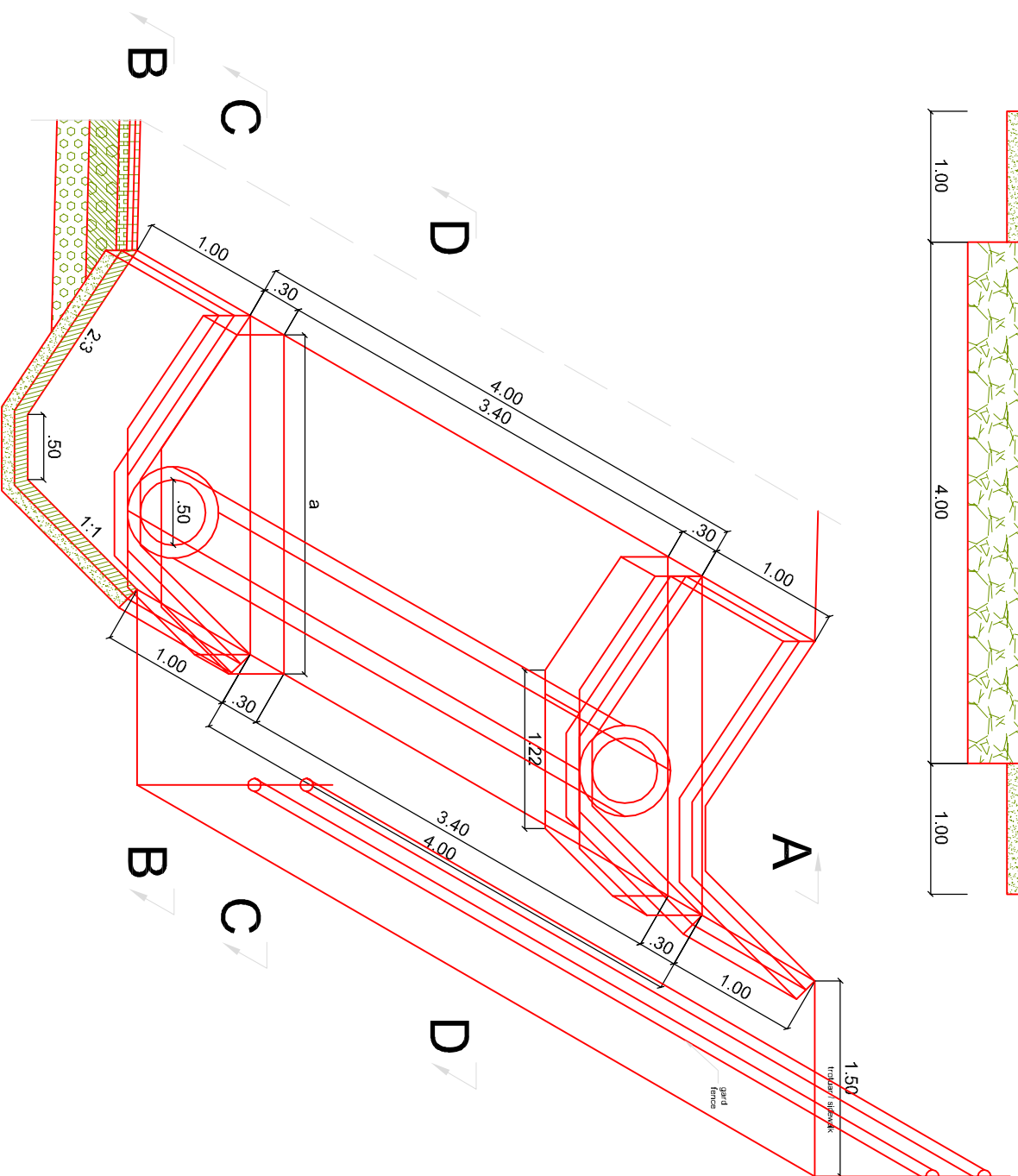
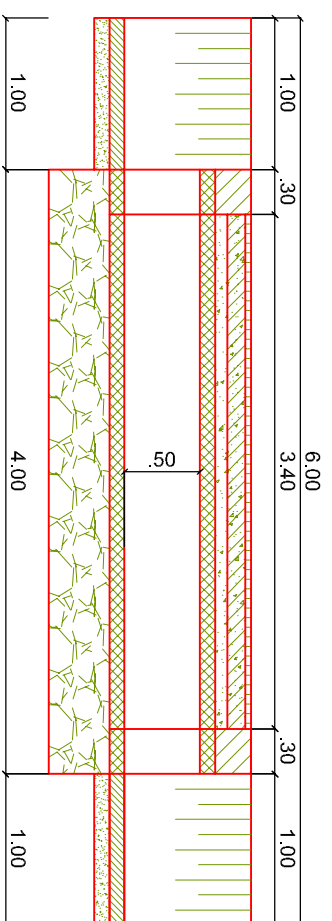

- NOTA:
1. Tubul prefabricat se va racorda cu santurile proiectate astfel incat sa se asigure scurgerea apelor din proiect.
 2. Dimensiunile a, b si c sunt variabile in functie de santurile proiectate in zona accesului.
- NOTE:
1. The precast tube will be connected to the ditches designed in order to ensure the discharge of water in accordance with the design.
 2. The a, b, c dimensions are variable depending on the ditches designed in the access area.

SECTIUNE B-B / B-B SECTION

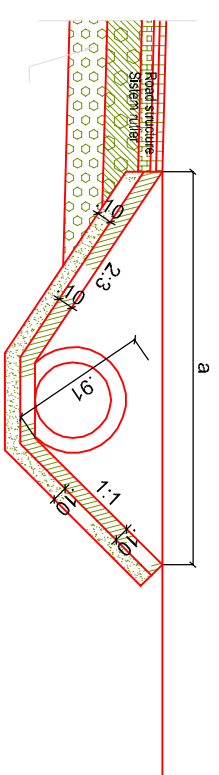

SECTIUNE C-C / C-C SECTION

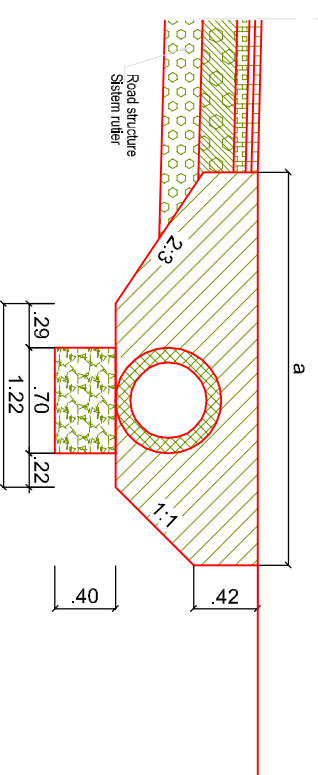

SECTIUNE D-D / D-D SECTION

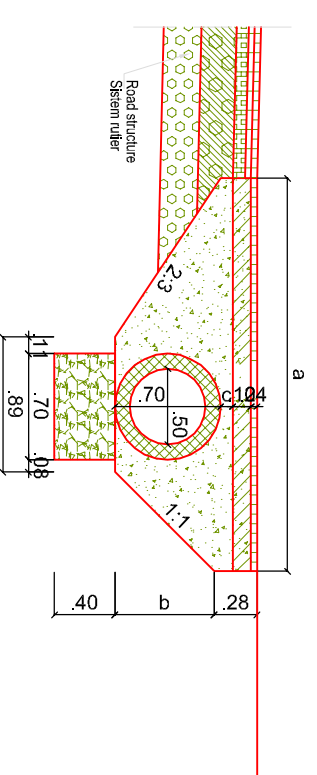

Beneficiar / Beneficiary:	COMPARNA NATIONALA DE AUTOSTRAZI SI DRUMURI NATIONALE DIN ROMANIA - S.A. THE NATIONAL COMPANY OF MOTORWAYS AND NATIONAL ROADS FROM ROMANIA	Consultant:	Nominated Subcontractor: INOCSA Tractebel Engineering SVEZ	Technical assistance for reviewing and updating the feasibility study, elaboration of detailed design, drawings and tender documents for the rehabilitation of Nr 6 Alexandria - Craiova section and construction of Alexandria BY-PASS Task II (b) ALEXANDRIA, KM 0+000 - KM 13+276 Nr. Contract / Contract no.: ISPA 2005/RO/16/PP/PA0003/02	Faza Phase
Director proiect / Team leader:	Ing. Antonio J. ASENULO VERGARA			Scara / Scale:	PT+DE
Desenat / Drawn:	Ing. Marius DUMITRU			1:50	DDD
Proiectat / Designed:	Ing. Christian ANTIPIA				
Verificat / Checked:	Ing. Adian SIMESCU			Data / Date: May 2009	
				Denumire planșa / Drawing name:	
					PODET TUBULAR LA DRUMURI LATERALE TUBE CULVERT FOR SIDE ROADS
				Nr. planșa / Drawing no: DNG-DE-1294-50ET - 007a	Rev: 0